

SECTION 000110 – TABLE OF CONTENTS

SPECIFICATIONS FOR CONSTRUCTION

Project: Lester Elementary School & Pierce Downer Playground Improvements – Phase II

Lester Elementary School
236 Indianapolis Avenue
Downers Grove, IL 60516

Pierce Downer Elementary School
1436 Grant Street
Downers Grove, IL 60515

Project Number: 200036

Owner: Board of Education
Downers Grove Grade School District 58 Administration Center
2300 Warrenville Rd
Suite 200 NE
Downers Grove, IL 60515

Architect: Wight and Company
2500 North Frontage Road
Darien, Illinois 60561
630-969-7000

Division	Section Title
----------	---------------

PROCUREMENT AND CONTRACTING DOCUMENTS GROUP

DIVISION 00 - PROCUREMENT AND CONTRACTING REQUIREMENTS

000415 SCHEDULE OF VALUES
001116 NOTICE TO BIDDERS
002113 INSTRUCTIONS TO BIDDERS
002213 SUPPLEMENTARY INSTRUCTIONS TO BIDDER
004100 BID FORM
004343 PREVAILING WAGE ACT
006000 PROJECT FORMS
007300 SUPPLEMENTARY CONDITIONS

SPECIFICATIONS GROUP

General Requirements Subgroup

DIVISION 01 - GENERAL REQUIREMENTS

011000 SUMMARY

012500	SUBSTITUTION PROCEDURES
012519	SUBSTITUTION REQUEST FORM
012600	CONTRACT MODIFICATION PROCEDURES
012900	PAYMENT PROCEDURES
013100	PROJECT MANAGEMENT AND COORDINATION
013200	CONSTRUCTION PROGRESS DOCUMENTATION
013300	SUBMITTAL PROCEDURES
013333	DIGITAL DATA TRANSMITTAL
014000	QUALITY REQUIREMENTS
014200	REFERENCES
015000	TEMPORARY FACILITIES AND CONTROLS
016000	PRODUCT REQUIREMENTS
017300	EXECUTION REQUIREMENTS
017419	CONSTRUCTION WASTE MANAGEMENT AND DISPOSAL
017700	CLOSEOUT PROCEDURES
017823.16	MAINTENANCE DATA
017839	PROJECT RECORD DOCUMENTS
018113.26	SUSTAINABLE DESIGN REQUIREMENTS

Facility Construction Subgroup

DIVISION 02 - EXISTING CONDITIONS

024113.13	PAVING REMOVAL
024113.15	SAW CUTTING PAVEMENT

DIVISION 11 - PLAYFIELD EQUIPMENT & STRUCTURES

116800	PLAY FIELD EQUIPMENT AND STRUCTURES
--------	-------------------------------------

DIVISION 31 - EARTHWORK

311000	SITE CLEARING
312000	EARTH MOVING
312333	TRENCHING AND BACKFILLING

DIVISION 32 - EXTERIOR IMPROVEMENTS

321216	HOT MIX ASPHALT PAVING
321373	CONCRETE PAVING JOING SEALANT
321383	PORTLAND CEMENT CONCRETE SIDEWALKS
321613	CONCRETE CURBS AND GUTTER
321816.13	PLAYGROUND PROTECTIVE SURFACING
323119.23	ORNAMENTAL FENCES
329200	LAWNS AND GRASSES

DIVISION 33 -UTILITIES

330513	MANHOLES AND STRUCTURES
334000	STORM DRAINAGE UTILITIES

END OF TABLE OF CONTENTS

**Lester Elementary School & Pierce Downer
Playground Improvements - Phase II
Downers Grove Grade School District 58**



000415 - SCHEDULE OF VALUES

1/27/2023

NOTES:

1. Bidder to complete Schedule of Values and enter total amount in appropriate space in Bid Form.
2. Owner's estimated quantities given for reference only. Bidder is responsible for performing all quantity take-offs necessary to estimate the work as drawn and specified.
3. The successful bidder will be required to enter into a lump sum contract agreement with the owner. No additional payments will be made due to discrepancies between bidder's estimated quantities, owner's estimated quantities, and the actual installed quantities to construct the work as drawn and specified.
4. This Schedule of Values form will become part of the Contract Documents and will be used as a basis for reviewing the Contractor's Applications for Payment.
5. This Schedule of Values form is available in Microsoft Excel format from the OWNER upon request.

Section	DESCRIPTION	Owner's Estimated QUANTITY	Bidder's QUANTITY	UNIT	UNIT COST	EXTENDED COST	SUBTOTAL
LESTER ELEMENTARY SCHOOL							
0 & 1	Contracting and General Requirements						
	Mobilization	1		LS			
	Layout	1		LS			
	Project Management	1		LS			
Contracting and General Requirements Subtotals:							
116800	Play Field Equipment & Structures						
	Purchase of Playground Equipment	1		LS		By Owner	
	Installation of Playground Equipment (mulch work incidental)	1		LS			
Section Subtotal:							
311000	Site Clearing						
	Silt Fence	417		LF			
	Inlet Protection	1		EA			
	Tree Protection Fence	275		LF			
	Temporary Construction Fence	784		LF			
	Removal of Playground Equipment	1		LS			
	Removal of Asphalt Paving	1,140		SF			
	Removal of Concrete Curb	126		LF			
	Excavation, Stockpile, and Respread of Existing Engineered Wood Fiber (aggregate, filter fabric incidental)	196		CY			
Section Subtotal:							

312000	Earth Moving
---------------	---------------------

Earthwork and Regrading	1		LS			
Topsoil Strip and Respread (amended soils incidental)	173		CY			
						Section Subtotal:

321216	Asphalt Paving
---------------	-----------------------

Vehicular Asphalt Paving	1,358		SF			
						Section Subtotal:

321313	Concrete Paving and Curbs
---------------	----------------------------------

Concrete Paving	275		SF			
Playground Curb	133		LF			
Playground Ramp	97		SF			
						Section Subtotal:

321816	Playground Protective Surfacing
---------------	--

Engineered Wood Fiber Mulch (mulch, filter fabric, aggregate incidental, and including 20% of existing play area)	70		CY			
						Section Subtotal:

323119.23	Oranmental Fence
------------------	-------------------------

4' Ornamental Fence	248		LF			
						Section Subtotal:

329200	Turf and Grass
---------------	-----------------------

Sod	1,311		SY			
Mulch	5		CY			
						Section Subtotal:

334200	Storm Utitily Drainage Piping
---------------	--------------------------------------

Cleanout	1		EA			
6" Underdrain (pipe, aggregate, filter fabric incidental)	120		LF			
4" Underdrain (pipe, aggregate, filter fabric incidental)	207		LF			
structure adjustment	1		EA			
4"x4" WYE	3		EA			
Connect to Existing Storm Sewer	1		LS			
						Section Subtotal:

LESTER ELEMENTARY SCHOOL BID TOTAL:

Section	DESCRIPTION	Owner's Estimated QUANTITY	Bidder's QUANTITY	UNIT	UNIT COST	EXTENDED COST	SUBTOTAL
---------	-------------	----------------------------------	----------------------	------	--------------	------------------	----------

PIERCE DOWNER ELEMENTARY SCHOOL PHASE II

0 & 1 Contracting and General Requirements

Mobilization	1		LS				
Layout	1		LS				
Project Management	1		LS				
Contracting and General Requirements Subtotals:							

116800 Play Field Equipment & Structures

Purchase of Playground Equipment	1		LS		By Owner		
Installation of Playground Equipment	1		LS				
Section Subtotal:							

311000 Site Clearing

Silt Fence	497		LF				
Inlet Protection	3		EA				
Tree Protection Fence	100		LF				
Temporary Construction Fence	541		LF				
Removals of Playground Equipment	1		LS				
Removal of Asphalt Paving	143		SF				
Removal of Timbers	245		LF				
Removal of Pea Gravel Play Surfacing	128		CY				
Removal and Salvage of Bench	1		EA				
Section Subtotal:							

312000 Earth Moving

Earthwork and Regrading	1		LS				
Section Subtotal:							

321313 Concrete Paving and Curbs

Concrete Paving	185		SF				
Playground Ramp	97		SF				
Playground Curb	312		LF				
Concrete Thickened Edge	6		LF				
Section Subtotal:							

321400 Unit Paving

Brick Unit Pavers (Donor and Blank)	290		SF		By Owner		
Brick Unit Pavers Installation (concrete base, aggregate incidental)	290		SF				
Section Subtotal:							

321816 Playground Protective Surfacing							
Engineered Wood Fiber Mulch (mulch, filter fabric, aggregate incidental)	230		CY				
Section Subtotal:							

329200 Turf and Grass							
Sod	1,009		SY				
Section Subtotal:							

334200 Storm Utitily Drainage Piping							
Cleanout	1		EA				
2' Inlet with Frame and Closed Lid	1		EA				
8" Underdrain Pipe (pipe, aggregate, filter fabric incidental)	83		LF				
8" PVC Storm Sewer Pipe	52		LF				
Connect to Existing Storm Sewer	1		LS				
Section Subtotal:							

PIERCE DOWNER ELEMENTARY SCHOOL PHASE II BID TOTAL:

LESTER ELEMENTARY SCHOOL & PIERCE DOWNER ELEMENTARY SCHOOL PHASE II COMBINED BID TOTAL:

SECTION 116800 - PLAY FIELD EQUIPMENT AND STRUCTURES

PART 1 - GENERAL

1.1 SUMMARY

- A. This Section includes the following:
 - 1. Freestanding and composite playground equipment and structures.

1.2 SUBMITTALS

- A. Product Data: For each type of product indicated.
- B. Shop Drawings: Show fabrication and installation details for playground equipment and structures.
- C. Coordination Drawings: Plans, drawn to scale, on which the following items are shown and coordinated with each other, based on input from installers of the items involved:
 - 1. Extent of surface systems and use zones for equipment.
 - 2. Critical heights for playground surface or fall heights for equipment.
- D. Product certificates.

1.3 QUALITY ASSURANCE

- A. Installer Qualifications: An employer of workers trained and approved by manufacturer.
- B. Manufacturer Qualifications: A firm whose playground equipment components have been certified by IPEMA's third-party product certification service.
- C. Safety Standards: Provide playground equipment complying with or exceeding requirements in the following:
 - 1. ASTM F 1487.
 - 2. CPSC No. 325.
- D. Preinstallation Conference: Conduct conference at Project site.

1.4 WARRANTY

- A. Special Warranty: Manufacturer's standard form in which manufacturer agrees to repair or replace components of playground equipment that fail in materials or workmanship within specified warranty period.

1. Failures include, but are not limited to, the following:
 - a. Structural failures.
 - b. Deterioration of metals, metal finishes, and other materials beyond normal weathering.
2. Warranty Period: Five years from date of Final Acceptance.

PART 2 - PRODUCTS

2.1 PLAYGROUND EQUIPMENT FABRICATION

- A. Metal Frame: Fabricate main-frame upright support posts from metal pipe or tubing with cross-section profile and dimensions as indicated.
- B. Provide necessary rebates, lugs, and brackets to assemble units and to attach to other work.
- C. Provide castings that are sound and free of warp, cracks, blowholes, or other defects that impair strength or appearance.
- D. Composite Frame: Fabricate main-frame upright support posts from metal and plastic with profile and dimensions as indicated.
- E. Play Surfaces: Provide manufacturer's standard elevated drainable decks, platforms, landings, walkways, ramps, and similar transitional play surfaces.
- F. Elevated Play Surfaces: Guardrails or protective barriers completely surround elevated play surface except for access openings, if play-surface heights above protective surfacing exceeds the following for use by age group indicated:
 1. Elevated surface greater than 20 inches intended for use by children aged 2 through 5.
 2. Elevated surface greater than 30 inches intended for use by children aged 5 through 12.
- G. Stepped Play Surfaces: Provide manufacturer's standard infill between stepped platforms according to referenced standards.
- H. Protective Barriers and Guardrails: Fabricate according to ASTM F 1487.
- I. Handrails: Welded metal pipe or tubing, OD between 0.95 and 1.55 inches. Provide handrails at height for use by age group indicated below:
 1. Ages: Between 2 and 5 and 5 and 12 years.
 2. Height of Top Surface: 29 inches intended for use by children aged 2 through 5 and 38 inches intended for use by children aged 5 through 12.
 3. Close exposed ends of handrails with returns with clearance of 1/4 inch or less.
- J. Roofs and Canopies: Manufacturer's standard plastic.

2.2 COMPOSITE PLAYGROUND EQUIPMENT AND STRUCTURES

- A. Composite Structure has been pre-purchased by the Downers Grove Grade School District 58.
 - 1. Pierce Downer Elementary Playground: Landscape Structures / NuToys
 - 2. Lester Elementary Playground: Burke / Play Illinois
- B. See itemized quotes following this spec section.
- C. Contractor shall take delivery of both structures and is responsible for ensuring all parts are included in the delivery.

2.3 CAST-IN-PLACE CONCRETE

- A. Concrete Materials and Properties: Comply with requirements in Division 03 Section "Cast-In-Place Concrete" and ACI 301.
- B. Concrete Materials and Properties: Dry-packaged concrete mix complying with ASTM C 387.

2.4 FINISHES, GENERAL

- A. Comply with NAAMM's "Metal Finishes Manual for Architectural and Metal Products" for recommendations for applying and designating finishes.

PART 3 - EXECUTION

3.1 INSTALLATION, GENERAL

- A. General: Comply with manufacturer's written installation instructions, unless more stringent requirements are indicated. Anchor playground equipment securely, positioned at locations and elevations indicated.
 - 1. Maximum Equipment Height: Coordinate installed heights of equipment and components with finished elevations of protective surfacing. Set equipment so fall heights and elevation requirements for age group use and accessibility are within required limits. Verify that playground equipment elevations comply with requirements for each type and component of equipment.
- B. Post and Footing Excavation: Excavate holes for posts and footings as indicated in firm, undisturbed or compacted subgrade soil.
- C. Post Set on Subgrade: Level bearing surfaces with drainage fill to required elevation.
- D. Post Set with Concrete Footing: Comply with ACI 301 for measuring, batching, mixing, transporting, forming, and placing concrete.

1. Set equipment posts in concrete footing.
2. Embedded Items: Use setting drawings and manufacturer's written instructions to ensure correct installation of anchorages for equipment.

END OF SECTION 116800

Play Illinois, LLC

310 N. Grant Street, Westmont, IL 60559
Tel (844) 222-9990 Fax (844) 217-1113
www.playil.com



Date:12/1/22
Quote #: D58LesterElem548
**Accepted Approved Quotation,
Terms and Conditions**

In coordination with **BCI Burke Company, LLC**

Tel: (920) 921-9220

To: Kevin Barto
Downers Grove District 58
2300 Warrenville Road, Suite 200NE
Downers Grove, IL 60515
ID# 2224162

Signed: _____

Date: _____

Project Name: Lester Elementary West Playground
Project Location: 236 Indianapolis
Downers Grove, IL 60516

Prepared by	Estimated Ship Date	Payment Terms		
M. Chaidez	4-5 weeks after receipt of order	Net 30 Days.		
Item	Description	Unit Price	Quantity	Total
Equipment	Burke Structure Proposal #129-157548-1	\$19,218.00	1	\$19,218.00
Discount	Discount per OMNIA Contract # R220201	-\$1,345.26	1	-\$1,345.26
Freight	Delivery of Burke Equipment	\$586.21	1	\$586.21
Sales Tax	Please submit tax exempt form at time of order	0.00	0	-
TOTAL:				\$ 18,458.95

Margaret Chaidez

Title: Project Manager, Play Illinois, LLC



Pricing and Freight are valid for 30 days!

Thank you for the opportunity to provide this quote.
We look forward to filling your park & playground needs in the months and years to come!

Special Notes: Prices do not include site security, safety surfacing (unless shown in quoted items above), installation (unless shown in quoted items above) or sales tax (if applicable). Prices are based on standard colors per CURRENT YEAR BCI Burke Catalog. Custom colors, where available, would be an extra charge. Freight charges are predicated on all items being ordered and shipped at the same time.

Rock Clause: If excessive underground obstructions such as rock, coral, asphalt, concrete, pipes, drainage systems, root systems, water or any other unknown obstructions are discovered, additional charges will be added to the proposal.

In coordination with BCI Burke Company, LLC
"An ISO 9001:2008 and ISO 14001:2004 Certified Company"
PO Box 549 - Fond du Lac, WI 54936-0549 - Phone (920) 921-9220 - Fax (920) 921-9566 - www.bcburke.com
Play that Moves You®

TERMS: \$18,458.95 for Equipment and Freight will be invoiced at time of shipping.

FEATURED PLAY EVENTS



Verto Climber 3 Freestanding

Burke's unique Verto Climbers have one, two or three climbing sections that can be combined in various configurations for unlimited adventures!



RockIt Offset Panel

RockIt creates the thrill, excitement and challenge of rock climbing in a realistic, yet safe, playground environment. Kids love a challenge, and RockIt challenges them with options to go around, through or over the mountain!

DESIGN SUMMARY

Play Illinois, LLC is very pleased to present this proposal for consideration for the Lester Elementary West located in Downers Grove. BCI Burke Company, LLC has been providing recreational playground equipment for over 90 years and has developed the right mix of world-class capabilities to meet the initial and continuing needs of District 58. We believe our proposal will meet or exceed your project's requirements and will deliver the greatest value to you.

The following is a summary of some of the key elements of our proposal:

- Project Name: Lester Elementary West
- Project Number: 129-157548-1
- User Capacity: 34
- Age Groups: Ages 5-12 years
- Dimensions: 34' 11" x 24' 4"
- Designer Name: Tyler Hess

Play Illinois, LLC has developed a custom playground configuration based on the requirements as they have been presented for the Lester Elementary West playground project. Our custom design will provide a safe and affordable playground environment that is aesthetically pleasing, full of fun for all users and uniquely satisfies your specific requirements. In addition, proposal # 129-157548-1 has been designed with a focus on safety, and is fully compliant with ASTM F1487 and CPSC playground safety standards.

We invite you to review this proposal for the Lester Elementary West playground project and to contact us with any questions that you may have.

Thank you in advance for giving us the opportunity to make this project a success.

INFORMATION
MINIMUM FALL ZONE
SURFACED WITH
RESILIENT MATERIAL
AREA

561 SQ.FT.

PERIMETER
104 FT.

STRUCTURE SIZE

34' 11" x 24' 4"

STRUCTURE IS DESIGNED
FOR CHILDREN AGES:

- 6-23 MONTH OLDS
- 2-5 YEAR OLDS
- 5-12 YEAR OLDS
- 13 + YEAR OLDS



Registered
to ISO 9001



Registered
to ISO 14001



To verify product certification,
visit www.ipema.org

The play components identified
in this plan are IPEMA
certified. The use and layout of
these components conform to the
requirements of ASTM F1487.
To verify product certification,
visit www.ipema.org

The space requirements shown
here are to ASTM standards.
Requirements for other standards
may be different.

The use and layout of play
components identified in this plan
conform to the CPSC guidelines.
U.S. CPSC recommends the
separation of age groups in
playground layouts.



3 existing KidForce spinners removed

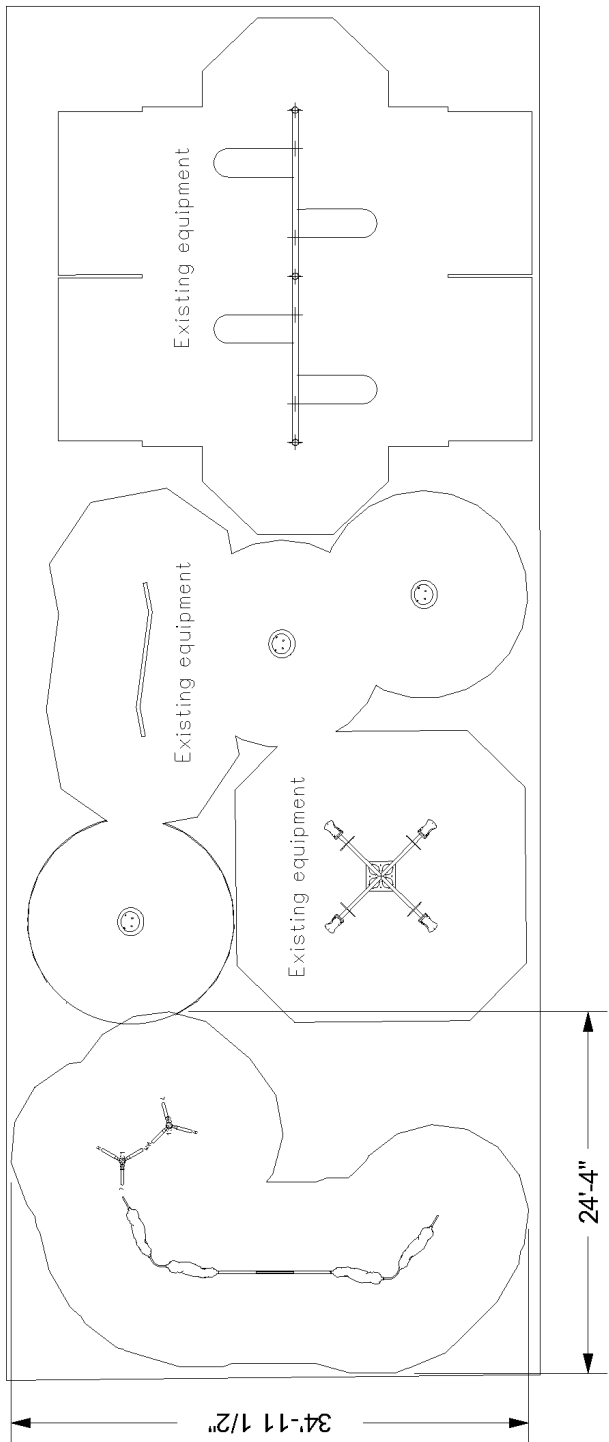

ADA ACCESSIBILITY GUIDELINE (ADAAG CONFORMANCE)

NUMBER OF PLAY EVENTS:	11
NUMBER OF ELEVATED PLAY EVENTS:	0
NUMBER OF ELEVATED PLAY EVENTS ACCESSIBLE BY RAMP:	PROVIDED: 0
NUMBER OF ELEVATED PLAY EVENTS ACCESSIBLE BY TRANSFER SYSTEM:	PROVIDED: 0
NUMBER OF ELEVATED PLAY EVENTS ACCESSIBLE BY RAMP OR TRANSFER SYSTEM:	PROVIDED: 11
NUMBER OF GROUND LEVEL PLAY EVENTS:	0
NUMBER OF TYPES OF GROUND LEVEL PLAY EVENTS:	PROVIDED: 2

WARNING!

ACCESSIBLE SAFETY SURFACING MATERIAL IS REQUIRED BENEATH
AND AROUND THIS EQUIPMENT.
FOR SLIDE FALL ZONE SURFACING AREA SEE CPSC's Handbook for
Public Playground Safety.
PLATFORM HEIGHTS ARE IN INCHES ABOVE RESILIENT MATERIAL.



SERIES: Nucleus
SITE PLAN
DRAWN BY: Tyler Hess

Lester Elementary West
236 Indianapolis
Downers Grove, IL 60516

August 05, 2022

Play Illinois, LLC
129-157548-1

ITEM	COMP.	DESCRIPTION
1	370-0851	VERTO CLIMBER 3 FS
2	560-0541	ROCKIT OFFSET PANEL
3	560-0545	ROCKIT END LADDER
4	560-0546	ROCKIT CURVED LADDER
5	560-0549	ROCKIT CORE LINK

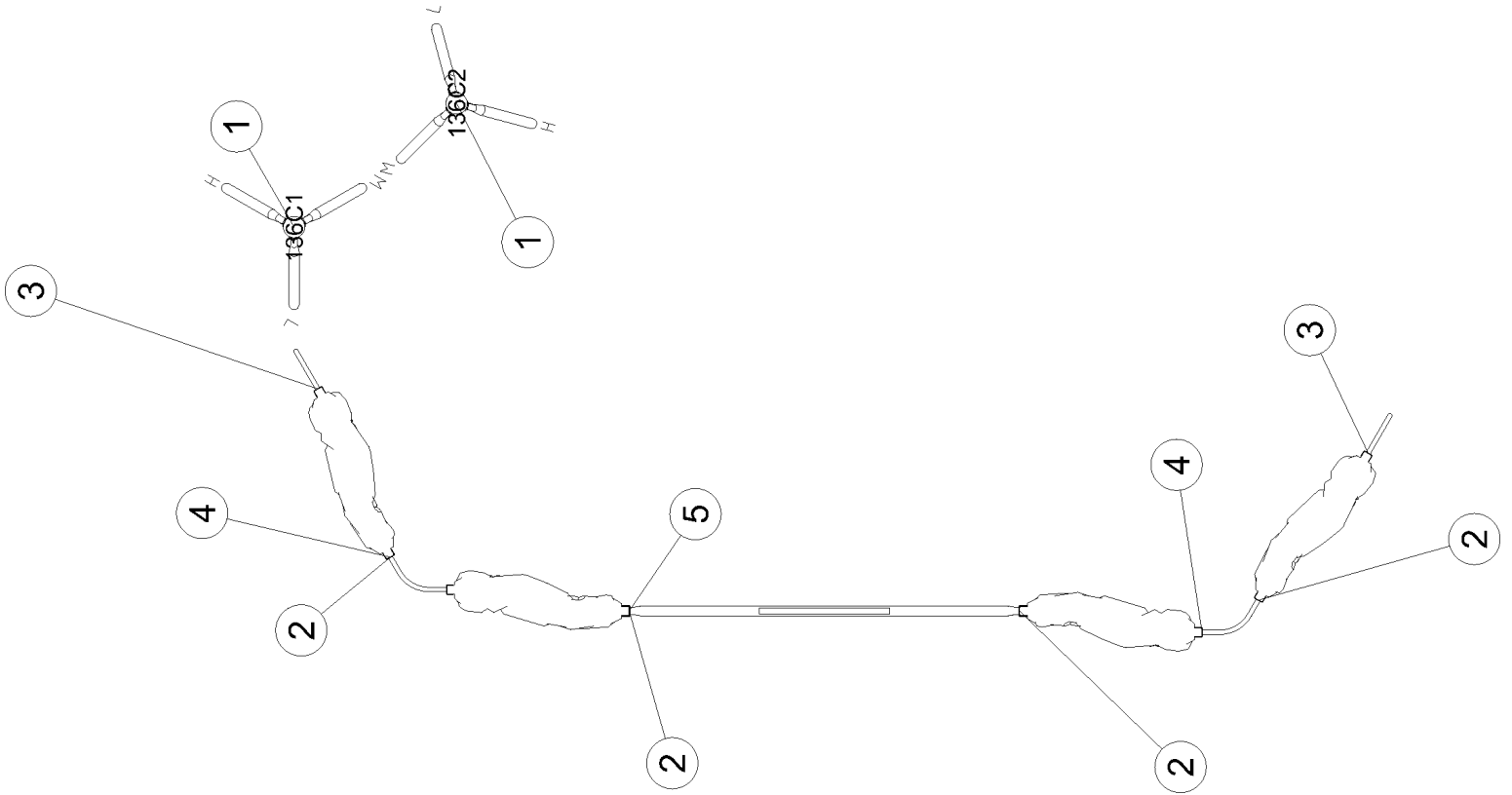

August 05, 2022

SERIES: Nucleus
 COMPONENT PLAN
 DRAWN BY: Tyler Hess

Lester Elementary West
 236 Indianapolis
 Downers Grove, IL 60516

Play Illinois, LLC
 129-157548-1

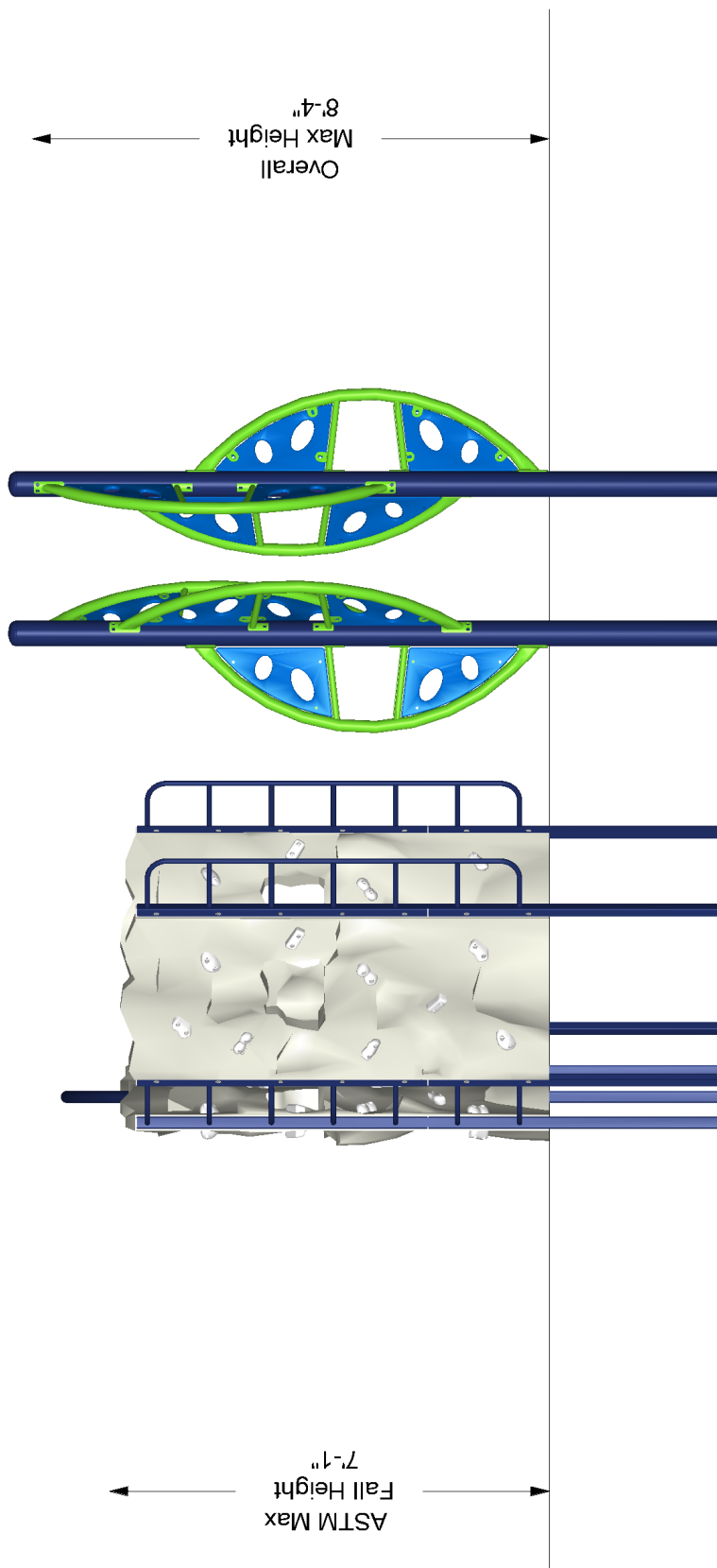

The protective surfacing for this design must accommodate the critical fall height.

Burke

August 05, 2022

SERIES: Nucleus
 ELEVATION PLAN
 DRAWN BY: Tyler Hess

Lester Elementary West
 236 Indianapolis
 Downers Grove, IL 60516

Play Illinois, LLC
 129-157548-1

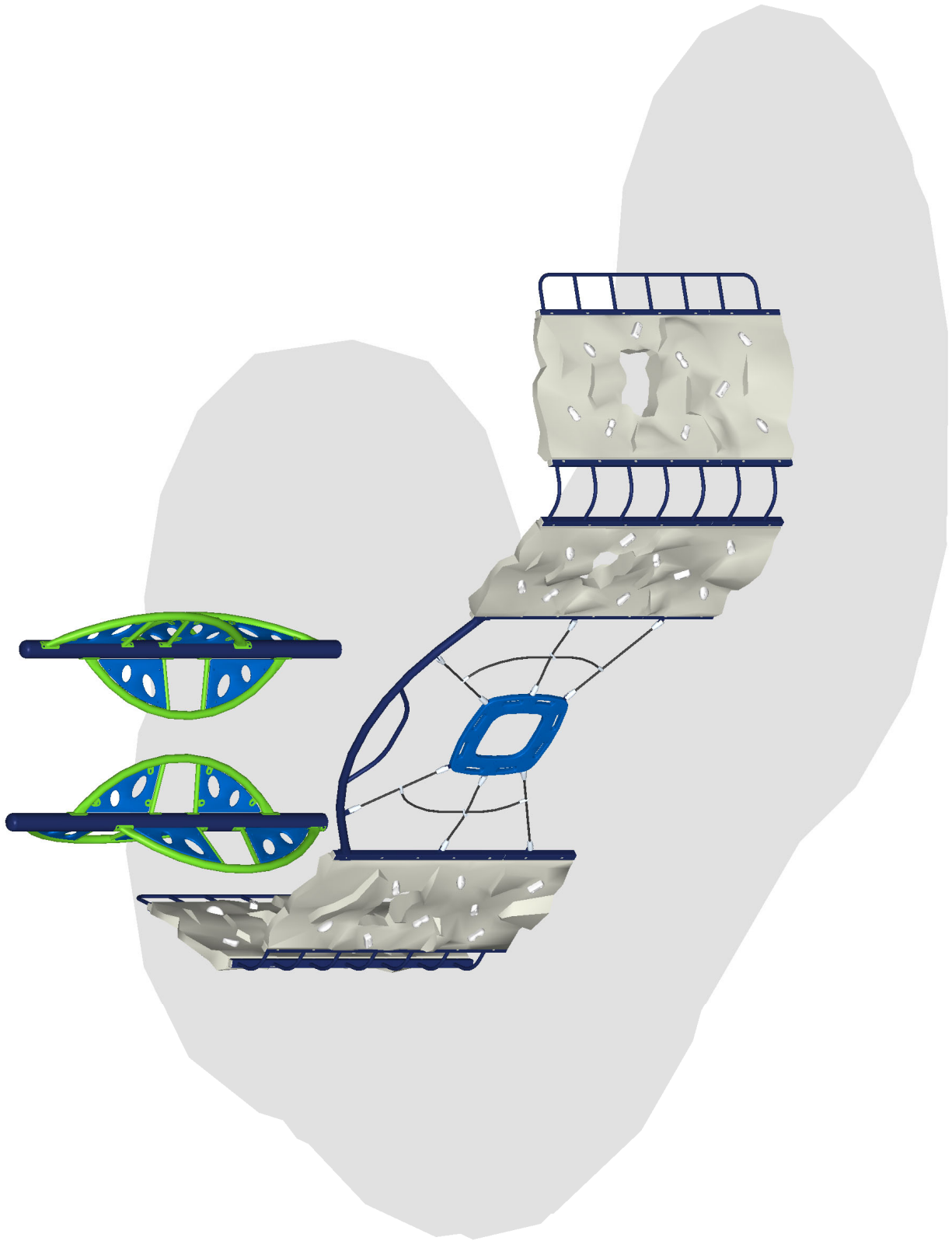

Burke

August 05, 2022

SERIES: Nucleus
ISOMETRIC PLAN
DRAWN BY: Tyler Hess

Lester Elementary West
236 Indianapolis
Downers Grove, IL 60516

Play Illinois, LLC
129-157548-1



Proposal # 129-157548-1

August 05, 2022
2022 Pricing

Proposal Prepared for:

Kevin Barto
District 58
2300 Warrenville Road, Suite 200NE
Downers Grove, IL 60515
Phone: 6307195858

Project Location:

Lester Elementary West
236 Indianapolis
Downers Grove, IL 60516

Proposal Prepared by:

Play Illinois, LLC
310 N Grant Street
Westmont, IL 60559
Phone: 844-222-9990
info@playil.com

Margaret Chaidez
Phone: 630-468-0506
mchaidez@playil.com

Component No.	Description	Qty	User Cap	Ext. User Cap	Weight	Ext. Weight
Nucleus						
072-0500-136C	5" OD X 136" CAPPED POST	2	0	0	71	142
370-0851	VERTO CLIMBER 3 FS	2	3	6	103	206
600-0104	NPPS SUPERVISION SAFETY KIT	1	0	0	3	3
660-0103	MAINTENANCE KIT, STRUCTURE	1	0	0	7	7
660-0104	INSTALLATION KIT, STRUCTURE	1	0	0	5	5
RockIt						
560-0541	ROCKIT OFFSET PANEL	4	4	16	83	331
560-0545	ROCKIT END LADDER	2	2	4	35	70
560-0546	ROCKIT CURVED LADDER	2	2	4	59	118
560-0549	ROCKIT CORE LINK	1	4	4	132	132

Total User Capacity: 34
Total Weight: 1,014 lbs.

Total Equipment Price: \$19,218.00
OMNIA Cooperative Purchasing Discount: (\$1,345.26)
Freight: \$586.21

TOTAL DELIVERED PRICE: \$18,458.95

Information is relative to the Aug 5 2022 4:35AM database.

Special Notes:

Prices do not include unloading, material storage, site excavation/preparation, removal of existing equipment, removal of excess soil from footing holes, site security, safety surfacing, installation, or sales tax (if applicable). Prices are based on standard colors per CURRENT YEAR BCI Burke Catalog. Custom colors, where available, would be an extra charge. **Pricing is valid for 30 days from the date of this proposal.**



Proposal # 129-157548-1

August 05, 2022

2022 Pricing

Selected Color List

Color Group	Color
<i>Phase 1</i>	
Post	Navy
RockIt	Sandstone
1 Color Extruded/Flat	Blue
Accessory	Lime

BURKE GENERATIONS WARRANTY®

The Longest and Strongest warranty in the industry

BCI Burke Company, LLC ("Burke") warrants that all standard products are warranted to be free from defects in materials and workmanship, under normal use and service, for a period of one (1) year from the date of shipment.

We stand behind our products. In addition, the following products are warranted, under normal use and service from the date of shipment as follows:

- One Hundred (100) Year Limited Warranty on aluminum and steel upright posts (including Intensity®, Synergy™, Nucleus®, Voltage®, Little Buddies®, ELEVATE®, ACTIVATE®, INVIGORATE™) against structural failure due to corrosion, deterioration or workmanship.
- One Hundred (100) Year Limited Warranty on KoreConnect® clamps against structural failure due to corrosion, deterioration or workmanship.
- One Hundred (100) Year Limited Warranty on Hardware (nuts, bolts, washers)
- One Hundred (100) Year Limited Warranty on bolt-through fastening and clamp systems (Synergy™, Intensity®, Nucleus®, Voltage®, Little Buddies®, ELEVATE®).
- Twenty-Five (25) Year Limited Warranty on spring assemblies and aluminum cast animals.
- Fifteen (15) Year Limited Warranty on structure platforms and decks, metal roofs, table tops, bench tops, railings and barriers against structural failure due to materials or workmanship.
- Fifteen (15) Year Limited Warranty on all plastic components including StoneBorders against structural failure due to materials or workmanship.
- Ten (10) Year Limited Warranty on ShadePlay Canopies fabric, threads, and cables against degradation, cracking or material breakdown resulting from ultra-violet exposure, natural deterioration or manufacturing defects. This warranty is limited to the design loads as stated in the specifications.
- Ten (10) Year Limited Warranty on NaturePlay® Boulders and GFRC products against structural failure due to natural deterioration or workmanship. Natural wear, which may occur with any concrete product with age, is excluded from this warranty
- Ten (10) Year Limited Warranty on Full Color Custom Signage against manufacturing defects that cause delamination or degradation of the sign. Full Color Custom Signs also carry a two (2) year warranty against premature fading of the print and graphics on the signs.
- Five (5) Year Limited Warranty on Intensity® and RopeVenture® cables and LEVEL X® flex bridge against premature wear due to natural deterioration or manufacturing defects. Determination of premature wear will be at the manufacturer's discretion.
- Five (5) Year Limited Warranty on moving parts, including swing components, against structural failure due to materials or workmanship.
- Five (5) Year Limited Warranty on PlayEnsemble® cables and mallets against defects in materials and workmanship.
- Three (3) Year Limited Warranty on electronic panel speakers, sound chips and circuit boards against electronic failure caused by manufacturing defects.

The warranty stated above is valid only if the equipment is erected in conformity with the layout plan and/or installation instructions furnished by BCI Burke Company, LLC using approved parts; have been maintained and inspected in accordance with BCI Burke Company, LLC instructions. Burke's liability and your exclusive remedy hereunder will be limited to repair or replacement of those parts found in Burke's reasonable judgment to be defective. Any claim made within the above stated warranty periods must be made promptly after discovery of the defect. A part is covered only for the original warranty period of the applicable part. Replacement parts carry the applicable warranty from the date of shipment of the replacement from Burke. After the expiration of the warranty period, you must pay for all parts, transportation and service charges.

Burke reserves the right to accept or reject any claim in whole or in part. Burke will not accept the return of any product without its prior written approval. Burke will assume transportation charges for shipment of the returned product if it is returned in strict compliance with Burke's written instructions.

THE FOREGOING WARRANTIES ARE EXCLUSIVE AND IN LIEU OF ANY OTHER WARRANTY, EXPRESS OR IMPLIED, INCLUDING BUT NOT LIMITED TO ANY IMPLIED WARRANTY OR MERCHANTABILITY OR FITNESS FOR A PARTICULAR PURPOSE. IF THE FOREGOING DISCLAIMER OF ADDITIONAL WARRANTIES IS NOT GIVEN FULL FORCE AND EFFECT, ANY RESULTING ADDITIONAL WARRANTY SHALL BE LIMITED IN DURATION TO THE EXPRESS WARRANTIES AND BE OTHERWISE SUBJECT TO AND LIMITED BY THE TERMS OF BURKE'S PRODUCT WARRANTY. SOME STATES DO NOT ALLOW THE EXCLUSION OF CERTAIN IMPLIED WARRANTIES, SO THE ABOVE LIMITATION MAY NOT APPLY TO YOU.

Warranty Exclusions: The above stated warranties do not cover: "cosmetic" defects, such as scratches, dents, marring, or fading; damage due to incorrect installation, vandalism, misuse, accident, wear and tear from normal use, exposure to extreme weather, immersion in salt or chlorine water, unauthorized repair or modification, abnormal use, lack of maintenance, or other cause not within Burke's control; and

Limitation of Remedies: Burke is not liable for consequential or incidental damages, including but not limited to labor costs or lost profits resulting from the use of or inability to use the products or from the products being incorporated in or becoming a component of any other product. If, after a reasonable number of repeated efforts, Burke is unable to repair or replace a defective or nonconforming product, Burke shall have the option to accept return of the product, or part thereof, if such does not substantially impair its value, and return the purchase price as the buyer's entire and exclusive remedy. Without limiting the generality of the foregoing, Burke will not be responsible for labor costs involved in the removal of products or the installation of replacement products. Some states do not allow the exclusion of incidental damages, so the above exclusion may not apply to you.

The environment near a saltwater coast can be extremely corrosive. Some corrosion and/or deterioration is considered "normal wear" in this environment. Product installed within 500 yards of a saltwater shoreline will only be covered for half the period of the standard product warranty, up to a maximum of five years, for defects caused by corrosion. Products installed in direct contact with saltwater or that are subjected to salt spray are not covered by the standard warranty for any defects caused by corrosion.

Contact your local Burke Representative for warranty information regarding Burke Turf® and Burke Tile products.

Terms of Sale

Pricing: Prices published in this catalog are in USD, are approximate and do not include shipping & handling, surfacing, installation nor applicable taxes. All prices are subject to change without notice. Contact your Burke representative for current pricing. Payments are to be made in USD.

Weights: Weights are approximate and may vary with actual orders.

Installation: All equipment is shipped unassembled. For a list of factory-certified installers in your area, please contact your Burke representative.

Specifications: Product specifications in this catalog were correct at the time of publication. However, product improvements are ongoing at Burke, and we reserve the right to change or discontinue specifications without notice.

Loss or Damage in Transit: A signed bill of lading is our receipt from a carrier that our shipment to you was complete and in good condition upon arrival. Before you sign, please check the Bill of Lading carefully when the shipment arrives to make sure nothing is missing and there are no damages. Once the shipment leaves our plant, we are no longer responsible for any damage, loss or shortage.

For more information regarding the warranty, call Customer Service at 920-921-9220 or 1-800-356-2070.

01/2022



Box 2121
 La Grange, IL 60525
 708-579-9055
 708-579-0109 (fax)
 1-800-526-6197

September 1, 2022

PIERCE DOWNER ELEMENTARY SCHOOL
 DOWNERS GROVE, IL
 OPTION 2 - REVISED
 PLAYBOOSTER COMPONENT SYSTEM

<u>QTY.</u>	<u>NO.</u>	<u>DESCRIPTION</u>	<u>UNIT PRICE</u>	<u>PRICE</u>
5-12 Year Olds Play Equipment				
1	120873B	84"Disc Challenge w/Handhold Panels 24"Deck Diff Attached To 16"Dk DB		\$ 3,475
1	120310A	Belt Bridge 84"		3,870
1	111345A	Bridge/Ramp Transition Bracket		345
1	158678A	Climbing Wall Alum DB		2,020
1	152907C	Deck Link w/Barriers Steel end panels 3 Steps		3,100
1	152907D	Deck Link w/Barriers Steel end panels 4 Steps		3,845
1	204176A	Flex Climber w/Permalene Handhold Equal Decks 72"Dk		9,825
1	201887B	JigJag Climber w/Permalene Handhold (Right) 72"Dk		2,075
1	165445A	Ring Tangle w/Handloop 8"Dk Diff		3,020
1	145624D	Vertical Ascent 72"Dk		1,570
1	CP011356	X BRACE FOR 4 SIDES OF BELOW 10FT SQUARE DECK (SET OF 4) These will be double stacked. This also requires 44i bury posts and single 60i sq x 48i deep footing.		2,630
2	122197A	90* Triangular Tenderdeck	\$ 1,000	2,000
1	152911B	Curved Transfer Module Left 40"Dk DB		3,205
2	111229A	Square Deck Extension	1,140	2,280
6	111228A	Square Tenderdeck	1,190	7,140
1	121949A	Tri-Deck Kick Plate 8"Rise		195
1	116244A	Pipe Barrier Above Deck		725
1	116244B	Pipe Barrier w/Wheel Above Deck		950
1	130565A	Table Panel DB		1,265
1	185346A	10' Tower SlideWinder2		6,445
1	222709A	10' Tower WhooshWinder Slide		7,420
2	120818A	Playstructure Seat	445	890
1	193174A	Sol Spinner DB		2,695
1	153165A	Stationary Cyclor Accessible		565
1	184489C	Overhead Trekker Ladder w/o Deck Connections DB		2,835
1	130873A	Ring Pull		760
2	111353A	Track Ride	3,040	6,080
1	111404G	100"Alum Post DB		340
5	111404F	108"Alum Post DB	345	1,725
4	111404E	116"Alum Post DB	355	1,420
3	111404D	124"Alum Post DB	415	1,245

Pierce Downer Elementary - Option 2 Revised

9	111404C	132"Alum Post DB	430	3,870
2	111404O	132"Steel Post DB 42" BURY	345	690
2	111404A	148"Alum Post DB	455	910
1	111404M	148"Steel Post DB		415
1	111404K	156"Alum Post DB		515
3	111404W	156"Steel Post DB	480	1,440
1	111404L	164"Alum Post DB		535
1	111404H	92"Alum Post DB		325
4	CP013847A	DTR PB 240"Steel Post for Roof 120"Deck 44"Bury	1,080	4,320
1	118110A	Square Poly Roof Custom Logo Panels PIERCE DOWNER		1,495
1	130390A	Double Swoosh Slide 72"Dk DB1		2,740
1	148426A	Firepole Perm Handholds 40"Dk DB		895
1	123333A	Rollerslide 40"Dk DB		8,755
2	120712A	Pod Climber 24" DB	\$ 340	680
1	158105A	Wobble Pod DB Only		1,775
1	182503C	Welcome Sign (LSI Provided) Ages 5-12 years DB		-
		Subtotal		<u>\$ 115,315</u>

ALSO:

1	186490A	We-saw DB Only		\$ 12,315
1	210117A	Oodle Swing Double DB Only		13,135
		Subtotal		<u>\$ 25,450</u>

Equipment Subtotal	\$ 140,765
Contract Discount - 8%	(11,261)
Shipping Costs	5,590
Equipment Total	<u>\$ 135,094</u>

****Note: Due to the volatile cost of raw materials, supply chain and labor shortages, prices and lead times can change without notice. Unfortunately, we cannot guarantee or hold prices quoted at this time.**

SECTION 321816.13 - PLAYGROUND PROTECTIVE SURFACING

PART 1 - GENERAL

1.1 SUMMARY

- A. This Section includes the following:
 - 1. Organic loose-fill surface.

1.2 SUBMITTALS

- A. Product Data: For each type of product indicated.
- B. Shop Drawings: Show the following:
 - 1. Installation details for curbs, ramps, and accessories.
 - 2. Location of wear mats in organic loose-fill surfaces.
 - 3. Location of drainage accessories.
- C. Samples: For each type of playground surface system indicated.
- D. Product certificates and test reports.
- E. Maintenance and warranty data.

1.3 QUALITY ASSURANCE

- A. Installer Qualifications: An employer of workers trained and approved by manufacturer.

1.4 WARRANTY

- A. Special Warranty: Manufacturer's standard form in which manufacturer agrees to repair or replace components of playground surface system that fail in materials or workmanship within specified warranty period.
 - 1. Failures include, but are not limited to, the following:
 - a. Reduction in impact attenuation.
 - b. Deterioration of surface and other materials beyond normal weathering.
 - 2. Warranty Period: Standard manufacturer's warranty.

PART 2 - PRODUCTS

2.1 ORGANIC LOOSE-FILL SURFACE

- A. Engineered Wood Fibers: Random-sized wood fibers, in manufacturer's standard fiber size, approximately 10 times longer than wide; containing no bark, leaves, twigs, or foreign or toxic materials according to ASTM F 2075; graded according to manufacturer's standard specification for material consistency for playground surfaces and for accessibility according to ASTM F 1951.

1. Available Products:
 - a. Homer Industries / Nature's Blanket Playground Surfacing
 - b. GameTime / GT Impax Fiber.
 - c. Fibar, Inc. / Fibar System 100.
2. Critical Height: 10 feet
3. Uncompressed Material Depth: Not less than as required for critical height indicated.

2.2 LOOSE-FILL ACCESSORIES

- A. Stabilizing Mats: Manufacturer's standard, water-permeable PVC or rubber mats tested for impact attenuation according to ASTM F 1292, and rated for use in the following locations, with anchoring system designed to anchor mat securely to subgrade through engineered wood:
 1. Location: At excessive wear areas and as follows:
 - a. Either On top of or below top of loose-fill surface, as directed by the Owner.
 - b. Under and in front of slide exits and swings.
 - c. At finished grade around transfer stations at accessible perimeter.
 2. Size: 48 by 48 inches.
 3. Color: Black.

2.3 GEOSYNTHETICS

- A. Drainage/Separation Geotextile: Nonwoven, needle-punched geotextile, manufactured for subsurface drainage applications and made from polyolefins or polyesters; complying with ASTM D 4759 and referenced standard test methods.

PART 3 - EXECUTION

3.1 INSTALLATION

- A. Prepare substrates to receive surfacing products according to playground surface system manufacturer's written instructions. Verify that substrates are sound and without high spots, ridges, holes, and depressions.
- B. Install underdrains, cleanouts, drainage layer and geosynthetics according to playground surface system manufacturer's and geosynthetic manufacturer's written instructions.
- C. Loose-Fill Systems:
 1. Loose Fill: Place playground surface system materials including manufacturer's standard amount of excess material for compacting mechanically to required depths after installation of playground equipment support posts and foundations.
 2. Stabilizing Mats: Coordinate installation of mats and mat anchoring system with placing and compacting of loose-fill.
 3. Compacting and Grading: Uniformly compact and grade loose-fill according to manufacturer's written instructions to an even surface free from irregular surface changes as indicated.
 4. Finish Grading: Hand rake to a smooth finished surface and to required elevations.

END OF SECTION 321816.13

SECTION 329200 - LAWNS AND GRASSES

PART 1 - GENERAL

1.1 SUMMARY

- A. Section Includes:
 - 1. Sodding.
 - 2. Fertilizer.
 - 3. Maintenance.

1.2 RELATED DOCUMENTS

- A. Drawings and general provisions of Contract, including General and Supplementary Conditions and other Division 1 Specification Sections, including, but not limited to:
 - 1. Section 311000 Site Clearing
 - 2. Section 312000 Earth Moving

1.3 REFERENCES

- A. Illinois Department of Transportation “Standard Specifications for Road and Bridge Construction” (Standard Specifications) most recent edition.

1.4 DEFINITIONS

- A. Finish Grade: Elevation of finished surface of planting soil.
- B. Manufactured Soil: Soil produced off-site by homogeneously blending mineral soils or sand with stabilized organic soil amendments to produce topsoil or planting soil.
- C. Planting Soil: Native or imported topsoil, manufactured topsoil, or surface soil modified to become topsoil; mixed with soil amendments.
- D. Subgrade: Surface or elevation of subsoil remaining after completing excavation, or top surface of a fill or backfill immediately beneath planting soil.
- E. Subsoil: All soil beneath the topsoil layer of the soil profile and typified by the lack of organic matter and soil organisms.
- F. Weeds: Vegetative species other than specified species to be established in given area.

1.5 SUBMITTALS

- A. Product Data: For seed mix, fertilizer, mulch and other accessories as indicated.

- B. Certification of grass seed and of each seed mixture for turfgrass sod.
- C. Operation and Maintenance Data: Include maintenance instructions, cutting method and maximum grass height; types, application frequency, and recommended coverage of fertilizer

1.6 INSPECTION

- A. Become familiar with project requirements, site and existing conditions impact on scope of work.
- B. Inspect existing conditions to verify all previous grading conforms with the drawings and specifications prior to commencing any work under this Section. Report any discrepancies to Landscape Architect.
- C. Failure to report discrepancies to Landscape Architect implies acceptance of existing conditions. Any necessary corrections will be at no cost to the Owner.

1.7 QUALITY ASSURANCE

- A. Installer's Field Supervision: Provide at least one person thoroughly trained and experienced in the skills required completely familiar with the design and application of the work described in this Section, and who shall be present at all times during progress of the work under this Section and shall direct all work required and performed under this Section.
- B. Provide seed mixture in containers showing percentage of seed mix, germination percentage, inert matter percentage, weed percentage, year of production, net weight, date of packaging, and location of packaging.
- C. Seed: Conform to current U.S. Department of Agriculture Rules and Regulations under the Federal Seed Act of August 9, 1939 and all subsequent revisions thereto, and the requirements of the state seed laws.
- D. Perform Work in accordance with Standard Specifications.
- E. Topsoil Analysis: Furnish soil analysis by a qualified soil-testing laboratory.
 - 1. Report suitability of topsoil for lawn growth. State-recommended quantities of nitrogen, phosphorus, and potash nutrients and soil amendments to be added to produce satisfactory topsoil.

1.8 QUALIFICATIONS

- A. Seed Supplier: Company specializing in manufacturing Products specified in this section with minimum three years documented experience.

- B. Installer: Company specializing in performing work of this section with minimum five years documented experience.

1.9 WORKMANSHIP

- A. During seeding, keep all areas neat and clean and with precautions taken to avoid damage to existing plants, turf and structures.
- B. Remove all debris and waste material resulting from seeding operations from the project and the area cleaned up upon completion of seeding operation.
- C. Repair or restore to original condition any damaged areas caused by the landscape contractor.

1.10 PROTECTION AND REPAIR

- A. Use all means necessary to protect site seeding areas before, during, and after installation and to protect the installed work and materials of all other trades.
- B. In the event of damage to the site seeding areas including mulch or erosion control blanket, immediately make all repairs or replacements necessary to the approval of the Owner and at all no additional cost to the Owner.
- C. Install necessary barricades, temporary fences or signs to protect newly seeded or hydro-seeded/mulched areas until acceptance of the Work.

1.11 DELIVERY, STORAGE, AND HANDLING

- A. Sod: Harvest, deliver, store, and handle sod according to requirements in TPI's "Specifications for Turfgrass Sod Materials" and "Specifications for Turfgrass Sod Transplanting and Installation" in its "Guideline Specifications to Turfgrass Sodding." Deliver sod in time for planting within 24 hours of harvesting. Protect sod from breakage and drying.
- B. Deliver grass seed mixture in sealed containers. Seed in damaged packaging is not acceptable.
- C. Deliver fertilizer in waterproof bags showing weight, chemical analysis, and name of manufacturer.
- D. Protect seed, and other required materials against weather conditions and injuries during transit and job storage.
- E. Deliver all items to the site in their original containers with all labels intact and legible at time of Owners representative inspection.
- F. Use all means necessary to protect all items before, during and after installation and to protect the installed work and materials of all trades

- G. Replacements:
 - 1. Repair all damaged or rejected materials immediately
 - 2. Make all repairs and replacements necessary to the approval of the Owners Representative at no additional cost to the owner.

1.12 GUARANTEE

- A. Guarantee this portion of the through the maintenance period and until final acceptance (See Part 3, Acceptance of this section.)
- B. Within the guarantee period, replace all lawn areas which have failed to flourish and produce a stand of turf acceptable to the Owner due to defective materials or workmanship, or unfavorable weather conditions.
- C. The decision of the Owner for replacement Work shall be conclusive and binding upon the Contractor.
- D. The Contractor is responsible for all damage to persons or property caused by defective materials or workmanship or by the re-working of areas not acceptable.

1.13 MAINTENANCE SERVICE

- A. Initial Lawn Maintenance Service: Provide full maintenance by skilled employees of landscape Installer. Maintain as required in Part 3.
 - 1. Begin maintenance immediately after each area is planted and continue until acceptable lawn is established. Minimally, maintenance activities shall occur from initial planting through 30-days after substantial completion.
 - 2. When initial maintenance period has not elapsed before end of planting season, or if lawn is not fully established, continue maintenance during next planting season.

PART 2 - PRODUCTS

2.1 TURFGRASS AND BUFFALO GRASS SOD

- A. Turfgrass Sod: Number 1 Quality/Premium, including limitations on thatch, weeds, diseases, nematodes, and insects, complying with TPI's "Specifications for Turfgrass Sod Materials" in its "Guideline Specifications to Turfgrass Sodding." Furnish viable sod of uniform density, color, and texture, strongly rooted, and capable of vigorous growth and development when planted.
 - 1. HGT sod by Sod Solutions, available from:
 - a. Payne Sod Farm / Manteno, IL 60950 / 815.468.6400 / www.paynesodfarm.com
 - b. Central Sod Farm / Plainfield, IL 60585 / 800.310.0402 / www.centernalsodil.com
 - 2. Turfgrass Species: Kentucky Bluegrass.

- B. Buffalo Grass Sod: shall be nursery grown sod consisting of a blend of 100% improved Buffalo Grass species and be a minimum of two years growth. Sod shall show evidence of dense well-rooted growth and be practically free from weeds and non-Buffalo Grass species. Grass height of sod shall be approximately 2 inches. Sod shall be raked free of undesirable debris. Sod shall be as specified as follows or an approved equal:
1. Buffalo Grass Sod shall be Legacy variety or approved equal.
 2. It shall contain no bent grass, quack grass or other noxious weed growth and shall be free from fungus and other pests and/or diseases.
 3. It shall be of firm, tough texture, having a compact growth of grass and good root development.
 4. The sod root zone shall be of good, fertile, natural field soil and free from stones and debris and the sod shall contain sufficient moisture to maintain its vitality during transportation.
- C. Harvesting of Sod:
1. Mowing: Before being cut and lifted, the sod shall have been mowed at least twice with a lawn mower, with the final mowing not more than seven days before the sod is cut.
 2. Cutting: The sod shall be carefully cut into uniform strips one inch thick, and 36-inches long. All strips shall be of the same width, which may be from 12-inches to 18-inches. Strips less than 12-inches or more than 18-inches in width will not be accepted. Each strip shall be rolled as compactly as is possible without breaking the turf.
 3. Sod cut for more than 24 hours shall not be used without the approval of the engineer.
- D. Inspection of Sod
1. All sod shall be fresh and green when placed. Any sod that is dried out, burned, inferior in quality, or in any way failing to meet the requirements of these specifications will be rejected and the Contractor shall immediately remove such rejected material from the premise and supply suitable material in its place.

2.2 TOPSOIL

- A. Topsoil: ASTM D 5268, pH range of 5.5 to 7, a minimum of 4 percent organic material content; free of stones 1 inch or larger in any dimension and other extraneous materials harmful to plant growth.
1. Topsoil Source: Reuse surface soil stockpiled on-site. Verify suitability of stockpiled surface soil to produce topsoil. Clean surface soil of roots, plants, sod, stones, clay lumps, and other extraneous materials harmful to plant growth.
 - a. Supplement with imported or manufactured topsoil from off-site sources when quantities are insufficient.
 2. Topsoil Source: Amend existing in-place surface soil to produce topsoil. Verify suitability of surface soil to produce topsoil. Clean surface soil of roots, plants, sod, stones, clay lumps, and other extraneous materials harmful to plant growth.
 - a. Surface soil may be supplemented with imported or manufactured topsoil from off-site sources.

2.3 AMENDED TOPSOIL

- A. Soil Amendments: EQ Biosolids/Compost, available from MWRD of Greater Chicago.
1. Install at a rate of ¼" depth for sodding operations.
 2. Till into soil prior to installing sod.
 3. Visit www.mwrd.org/eq-compost to order on line, or call (708) 657-7591.
 4. This is a time sensitive item – it will be available again in the spring.

2.4 FERTILIZER

- A. Commercial Fertilizer: Commercial-grade complete fertilizer of neutral character, consisting of fast- and slow-release nitrogen, phosphorous, and potassium. Provide both fertilizers at the specified rates, total target of 1 LB/1000 SF of nitrogen.
1. Pro Ap Professional Turf Fertilizer 12-25-12 with 25% Duration starter fertilizer, available from National Seed, or equal:
 - a. N-Nitrogen 13%
 - 1) 9.75% Ammoniacal Nitrogen
 - 2) 3.25% Urea Nitrogen
 - b. P-Phosphoric Acid 25%
 - c. K-Potash 12%
 - d. Application rate: 4 LB/1000 SF = N 0.52 LB, P 1.0 LB and K 0.48 LB
 - 1) 50-pound bag will cover 12,500 SF
 2. EndoRoots 3-3-4 with mycorrhizae, available from Nation Seed, or equal:
 - a. N-Nitrogen 3%
 - b. P-Phosphate 3%
 - c. K-Soluble Potash 4%
 - d. Application Rate: 16.6 LB/1000 SF = N 0.5 LB, P 0.5 LB, K 0.7 LB
 - 1) 50-pound bag will cover 3,000 SF

PART 3 - EXECUTION

3.1 LAWN PREPARATION

- A. Newly Graded Subgrades: Loosen subgrade to a minimum depth of 8 inches. Remove stones larger than 1 inch in any dimension and sticks, roots, rubbish, and other extraneous matter and legally dispose of them off Owner's property.
1. Thoroughly blend planting soil mix off-site before spreading or spread topsoil, apply soil amendments and fertilizer on surface, and thoroughly blend planting soil mix.
 2. Spread planting soil mix to a depth of 6 inches but not less than required to meet finish grades after light rolling and natural settlement. Do not spread if planting soil or subgrade is frozen, muddy, or excessively wet.
 - a. Reduce elevation of planting soil to allow for soil thickness of sod.
- B. Unchanged Subgrades: If lawns are to be planted in areas unaltered or undisturbed by excavating, grading, or surface-soil stripping operations, prepare surface soil as follows:

1. Remove existing grass, vegetation, and turf. Do not mix into surface soil.
 2. Loosen surface soil to a depth of at least 8 inches. Apply soil amendments and fertilizers according to planting soil mix proportions and mix thoroughly into top 6 inches of soil. Till soil to a homogeneous mixture of fine texture.
 3. Remove stones larger than 1 inch in any dimension and sticks, roots, trash, and other extraneous matter.
 4. Legally dispose of waste material, including grass, vegetation, and turf, off Owner's property.
- C. Finish Grading: Grade planting areas to a smooth, uniform surface plane with loose, uniformly fine texture. Grade to within plus or minus 1/2 inch of finish elevation. Roll and rake, remove ridges, and fill depressions to meet finish grades. Limit finish grading to areas that can be planted in the immediate future.
- D. Moisten prepared lawn areas before planting if soil is dry. Water thoroughly and allow surface to dry before planting. Do not create muddy soil.
- E. Before planting, restore areas if eroded or otherwise disturbed after finish grading.
- F. If, as a result of rain, the prepared seed bed becomes crusted or eroded, or if eroded places, ruts, or depressions exist for any reason, the Contractor shall rework the soil until it is smooth and reseed such areas which are reworked. After the area has been properly shaped, fertilized, and seeded, the blanket shall be laid out flat, evenly, and smoothly, without stretching the material. The erosion control blanket shall be placed so that the netting is on the top and the fibers are in contact with the soil.
- G. For placement in ditches, the erosion control blanket shall be applied parallel to the centerline of the ditch so that there are no longitudinal seams within 2 feet of the bottom centerline of the ditch. The blanket shall be toed in on the upslope edge and shingled or overlapped with the flow.
- H. On slopes, the blanket shall be applied either horizontally or vertically.

3.2 SODDING

- A. Lay sod within 24 hours of harvesting. Do not lay sod if dormant or if ground is frozen or muddy.
- B. Lay sod to form a solid mass with tightly fitted joints. Butt ends and sides of sod; do not stretch or overlap. Stagger sod strips or pads to offset joints in adjacent courses. Avoid damage to subgrade or sod during installation. Tamp and roll lightly to ensure contact with subgrade, eliminate air pockets, and form a smooth surface. Work sifted soil or fine sand into minor cracks between pieces of sod; remove excess to avoid smothering sod and adjacent grass.
 1. Lay sod across angle of slopes exceeding 1:3.
 2. Anchor sod on slopes exceeding 1:6 with wood pegs or steel staples spaced as recommended by sod manufacturer but not less than 2 anchors per sod strip to prevent slippage.

- C. Saturate sod with fine water spray within two hours of planting. During first week after planting, water daily or more frequently as necessary to maintain moist soil to a minimum depth of 2 inches below sod.

3.3 LAWN MAINTENANCE

- A. Maintain and establish lawn by watering, fertilizing, weeding, mowing, trimming, replanting, and other operations, until work under this contract has been completed and accepted by the Owner.
 - 1. Watering:
 - a. The seed bed shall be kept moist but not wet during the period of seed germination. Care must be taken that the seed bed does not dry out in spots.
 - b. During germination, the water shall penetrate to a depth of 1-inch into the seed bed.
 - c. After germination, as the grass roots go deeper into the soil, the quantity of water shall be increased so that the depth of penetration is a minimum of 3-inches.
 - d. If water is not available on site, the Contractor shall supply water from his own source. The Contractor shall furnish the hose and proper equipment for watering purposes.
- B. Roll, regrade, and replant bare or eroded areas and remulch to produce a uniformly smooth lawn. Provide materials and installation the same as those used in the original installation.
- C. Mow lawn as soon as top growth is tall enough to cut. Repeat mowing to maintain specified height without cutting more than 1/3 of grass height. Remove no more than 1/3 of grass-leaf growth in initial or subsequent mowings. Mowing operations shall be the sole responsibility of the contractor during construction and until substantial completion.

3.4 PROTECTION AND REPAIR

- A. The Contractor is responsible for the proper care of the seeded areas during the period when the vegetation is being established.
 - 1. Newly seeded areas shall be protected against traffic or other use, by enclosing the areas with snow fencing or other approved barrier.
 - 2. "NEWLY SEEDED" or other appropriate approved warning placards shall be posted until all work under the contract is completed and accepted.
- B. Repair: If at any time before completion and acceptance of the entire work covered by this contract, any portion of the surface becomes gullied or otherwise damaged following seeding, dies due to lack of water, becomes rutted due to improper protection, has been winter-killed or otherwise damaged or destroyed, the affected portion shall be repaired to re-establish the condition and grade of the soil prior to seeding and shall then be reseeded as specified herein by the Contractor, at no additional cost to the Owner.

3.5 SATISFACTORY LAWNS

- A. Satisfactory Seeded Lawn: At end of maintenance period, a healthy, uniform, close stand of grass has been established, free of weeds and surface irregularities, with coverage exceeding 90 percent over any 10 sq. ft. and bare spots not exceeding 5 by 5 inches.
- B. Satisfactory Sodded Lawn: At end of maintenance period, a healthy, well-rooted, even-colored, viable lawn has been established, free of weeds, open joints, bare areas, and surface irregularities.
- C. Use specified materials to reestablish lawns that do not comply with requirements and continue maintenance until lawns are satisfactory.

3.6 ACCEPTANCE

- A. Completion of the Work: Upon completion of work, the Contractor shall notify the Landscape Architect and the Owner at least ten (10) days prior to requested date of substantial completion of all or portions of the work. Landscape Architect will review all the work and prepare a punch list of work not installed or not installed in conformance with the contract documents. All work in the punch list must be completed within five (5) working days from date of issue. Where work does not comply with requirements, replace rejected work and continue specified protection and maintenance until reviewed by Landscape Architect and found to be acceptable.
- B. Certificate of Substantial Completion: Certificate of substantial completion will be issued for acceptable work at sole discretion of the Landscape Architect. If punch list items are issued with the certificate, they must be corrected within five (5) working days. If items are not corrected within five (5) working days than the certificate of substantial completion will be revoked and reissued when the punch list items are corrected.
- C. Final Acceptance: After the 30-day maintenance period following the date of substantial completion the Landscape Architect and the Owner will review the work for final acceptance. Upon satisfactory completion of repairs and / or replacements the Landscape Architect will certify, in writing, final acceptance of the work, which will serve as evidence that Contractor's obligations have been met.

END OF SECTION 329200